

# South Australia

(CERTIFICATE OF TITLE)



Register Book,

Vol. 2845 Folio 93

Pursuant to Memorandum of Acquisition No. 2250002 Registered on Vol. 283 Folio 169 and others

## THE COMMONWEALTH OF AUSTRALIA

is the proprietor of an estate in fee simple subject nevertheless to such encumbrances liens and interests as are notified by memorial underwritten or endorsed hereon in THOSE PIECES of land situated OUT OF HUNDREDS OUT OF COUNTIES being FIRSTLY the ALLOTMENTS 408 and 409 and PORTION OF ALLOTMENTS 407 and 410 in the TOWN OF FARINA and SECONDLY PORTION OF SECTION 46 SUBURBAN TO FARINA WHICH said pieces of land are more particularly delineated and bounded as appears in the plan in the margin hereof and therein colored green

Allotments and Which said/Section are delineated in the public maps of the said deposited in the Land Office at Adelaide.

In witness whereof I have hereunto signed my name and affixed my seal this *nineteenth* day of January 1961

Signed the *19th* day of January 1961, in the presence of *M. Holden*

Registrar-General.

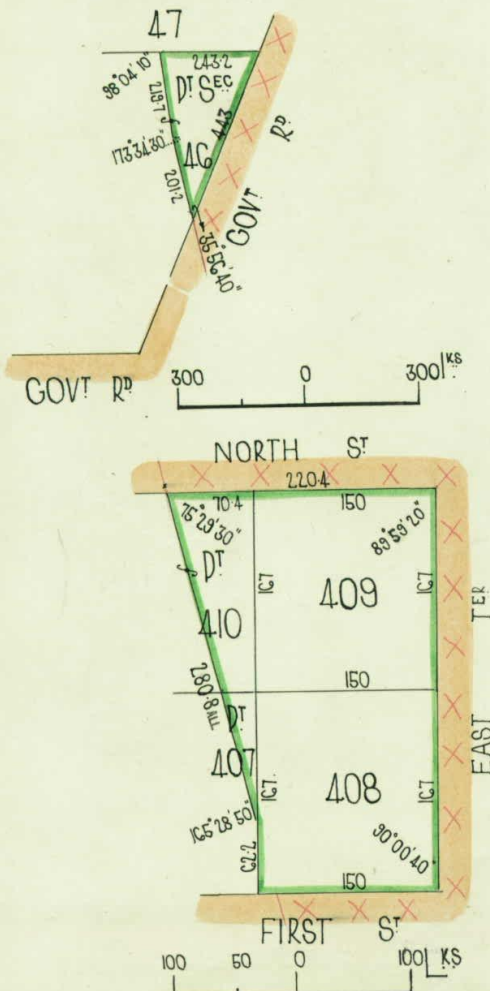

TRANSFER No. *2250003* to

*Commonwealth Railways Commissioner*  
*of 623 Collins Street Melbourne Victoria*  
 OF THE WITHIN LAND. PRODUCED *1/12/1960* AT *1/1/1961*

DEP. REG. GEN.

The roads adjoining the within land have been closed. Vide Confirmation of Road Order in Gazette dated 27th July, 1961 (Tracing No 4794)

Dep. Reg. Genl.

*See C.D. re Closed Road*  
*Consolidative vide Lr 4125/63*

CANCELLED  
 AND ISSUED VIDE *New* *Packet 4125* VOL *3574* FOL *164* 1963  
*B. Nelson* DEP. REG. GENL.

44